

Items List

RECOMMENDED TOOLS

1. Super Glue ¹
2. PVC Glue/Cement
3. Safety Knife/ Utility Knife/Scissors
4. Pipe Cutter/Hacksaw/Miter Saw/Nylon String ²
5. Rubber Mallet/Hammer

COMPONENTS

6. 4.546 L (1 gal) Paint Can (Outer Rigid Container)
7. Primary Receptacle
8. Absorbent Packing Material ³

Pipe & Fittings ONLY 76.2 mm (3 in) or less ⁴

9. Female Socket Cap
10. Unthreaded PVC Pipe
11. Straight Adapter, Female Socket x Female Threaded
12. Male Threaded End Cap
13. Non-absorbent (for liquids) Foam ⁵

¹Strong fast-acting adhesive

²Pipe cutting tool

³Paper towel, chemical absorbent pad, chemical wipes

⁴Corresponding normal pipe size (NPS) for pipe and fittings obtained

⁵EVA Foam, Polyethylene Foam

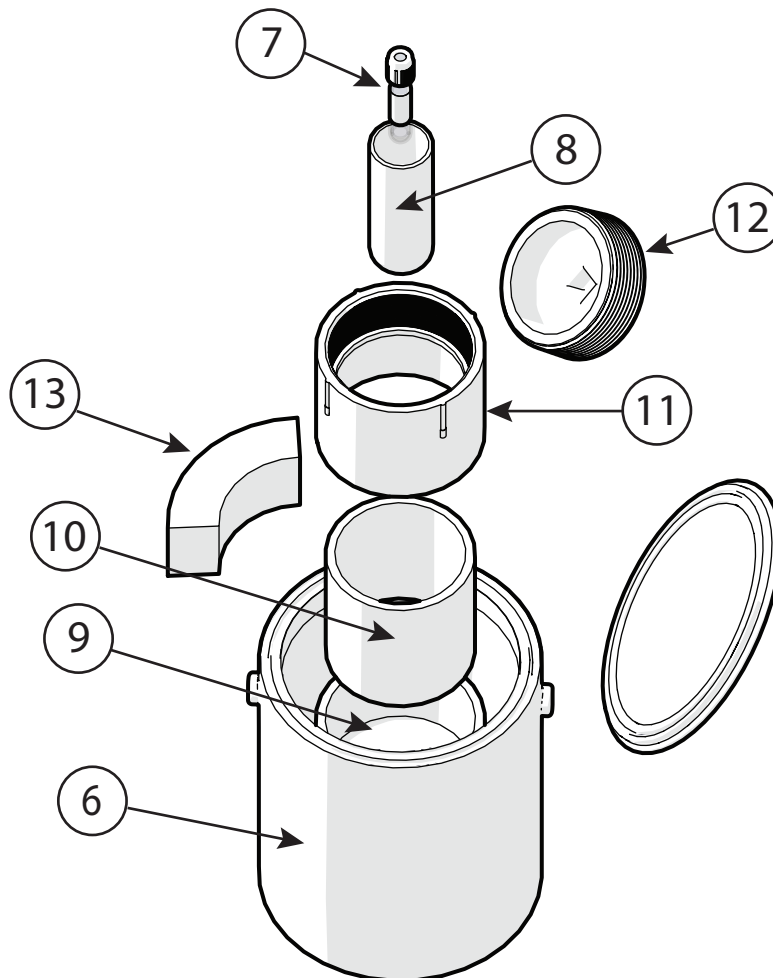

Assembly Guide DRAFT

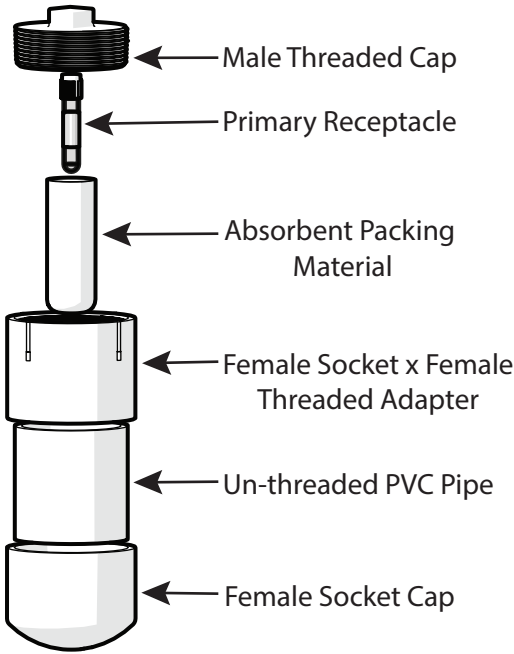

Corresponding normal pipe size (NPS) for pipe and fittings

1.

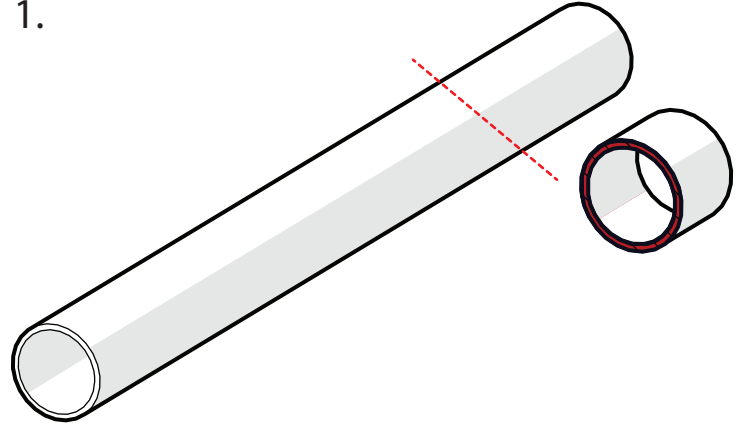

Safely, cut un-threaded PVC pipe to approximately 89 mm (3.5 in)* length with a pipe cutting tool.

* Length is dependent on size of primary receptacle and secondary container fit inside rigid outer container.

2.

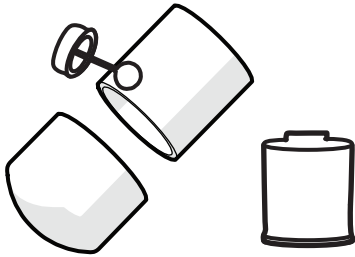

Apply liberal amount of PVC glue inside female socket cap and to the exterior of one end of un-threaded PVC Pipe. Join parts quickly, glue must be fluid. Turn adapter 1/4 of turn as you push into the female socket cap. Hold for 30 seconds and wipe off excess glue.

3.

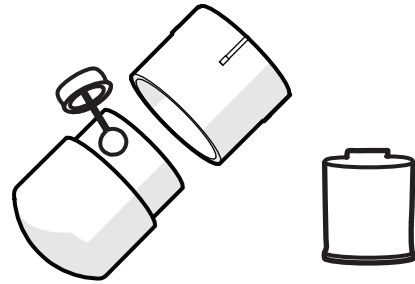

Apply liberal amount of PVC glue inside female socket end of the adapter and to the exterior of the other end of un-threaded PVC Pipe. Join parts quickly, glue must be fluid. Turn adapter 1/4 of turn as you push into the female socket cap. Hold for 30 seconds and wipe off excess glue.

4.

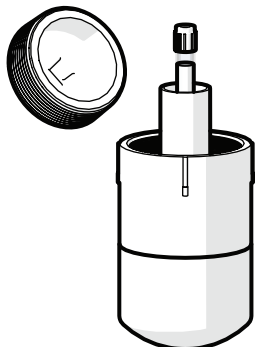

Package primary receptacle with absorbent packing material into secondary container. Screw male threaded cap into female threaded end of the adapter.

5.

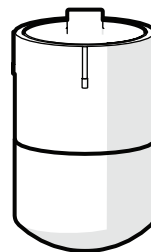

Assembled



Section View

6.

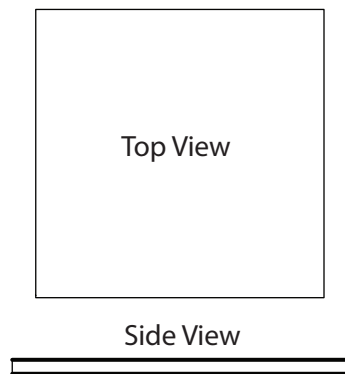

Non-absorbent (for liquids) foam. Recommended 127 mm X 127 mm (5 in X 5 in) sheet or larger.

8.

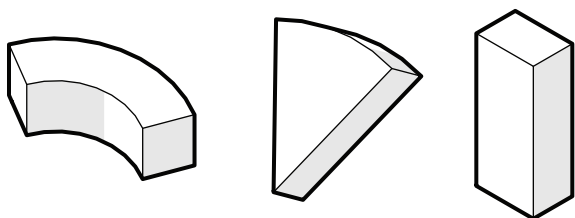

Shape Examples

Cut non-absorbent foam in wedge shape (see step 11). Shape must be large enough to wedge secondary container inside of outer rigid container.

10.

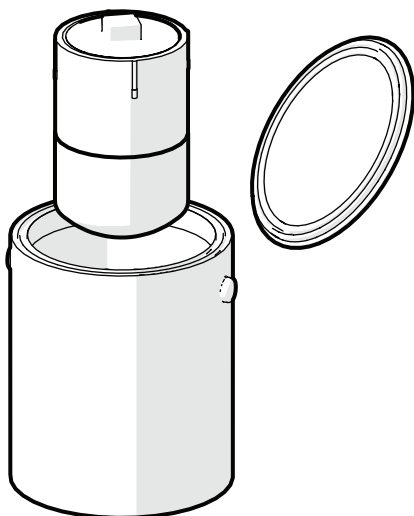

Place secondary container inside of rigid outer packaging.

7.

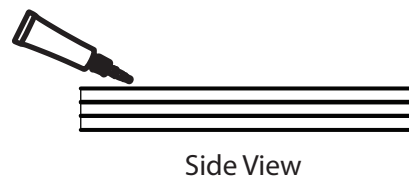

If foam is not thick enough to support secondary container (see step 9), use super glue to adhere layers of foam. Desired thickness is approximately 25 mm - 50 mm (1 in - 2 in).

9.

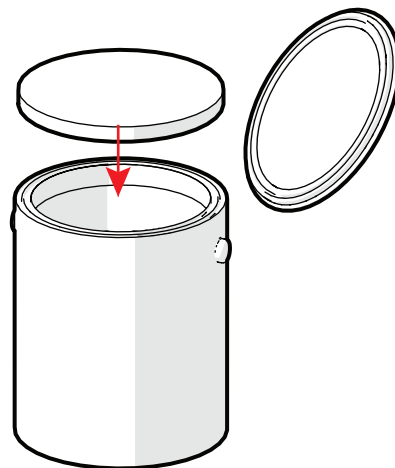

Cut a circular piece of non-absorbent foam to fit inside of rigid outer packaging, approximately 12.5 mm (1.5 in) thick and 165 mm (6.5 in) diameter*. Place first in outer packaging, may require bending to fit inside outer packaging.

*Diameter of non-absorbent foam is dependent on inner diameter of outer rigid container.

11.

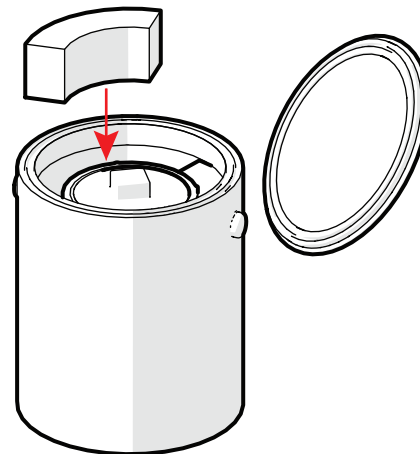

Wedge EVA foam pieces in between secondary container and outer packaging interior. Secondary container should hardly move.

12.



Gently hammer around lid to seal outer packaging.